

CROSS CONNECTION PLAN APPROVAL

HOW TO APPLY:

1. What is the purpose of this approval?

This is an approval for the installation of one cross connection control device. Public health and welfare is protected by insuring that the water supply system is protected from the backflow of contaminants. Proper cross connection control is necessary to insure the protection of drinking water supplies from these contaminants. Legislative authority is stated in MGL Chapter 111, Section 160A. Regulatory authority is stated in 310 CMR 22.22, Drinking Water Regulations.

2. Who must apply?

The owner of any facility who plans to maintain an actual or potential connection between a potable drinking water system and a non-potable source must obtain this approval prior to installation.

Please note, the cross connection regulations, 310 CMR 22.22, allow for public water systems to accept delegation and act as DEP's designee. Delegation allows the public water system to review and approve the installation plans for a backflow prevention device. Therefore, installations in public water systems that have accepted delegation do not require approval from DEP.

3. What other requirements should be considered when applying for this approval?

A permit from the local plumbing inspector must be applied for prior to installing cross connection control devices. Devices on fire sprinklers must be approved by the local fire department prior to installation.

4. What is the application fee?

The application fee is \$50 for each testable device. There is no fee for non-testable devices.

5. What is the Primary Permit Location?

Town Office Building
141 Main Street
Haydenville, MA 01039

6. What is the annual compliance fee from the Department of Environmental Protection?

The annual compliance assurance fee for this approval is \$50.

7. How long is this approval in effect?

This approval is in effect as long as the applicant remains in compliance with appropriate laws and regulations or until the permittee notifies Williamsburg Water Department of a change in status. The owner or owner's agent must notify Williamsburg Water Department in writing no later than thirty days prior to the removal from service of any permitted device. Such notification must include the reason for removal and whether the cross connection has been eliminated. The owner or owner's agent must also notify Williamsburg Water Department in writing no later than thirty days prior to any change in ownership. Notification must include, at a minimum, the name and address of the new owner as well as documentation of proof of change of ownership.

8. How can I avoid the most common mistakes made applying for this approval?

- a. Answer all questions on the application form and indicate not applicable where appropriate.
- b. All drawings must include information requested on the design data sheet.
- c. Submit fee made payable to the Town of Williamsburg and application to:
Town Collector, P.O. Box 488, Haydenville, MA 01039
Attn: Cross Connection Control Program

9. What are the regulations that apply to this approval? Where can I get copies?

These regulations include, but are not limited to:

- a. Drinking Water Regulations, 310 CMR 22.00.
- b. Timely Action Schedule and Fee Provisions, 310 CMR 4.00.

These may be purchased at:

State Bookstore (in State House)
Room 116
Boston, MA 02133
(617) 727-2834

State Bookstore
436 Dwight Street
Springfield, MA 01103
(413) 784-1376



Office of the Water and Sewer Commission

141 Main Street, P.O. Box 447

Haydenville, Massachusetts 01039-0447

Phone: (413) 268-8430

Fax: (413) 268-8409

Walter Kellogg
WATER SUPERINTENDENT

A

Owner Information

Name

Address

Phone Number

B

Facility Information

Facility Name

Address

Contact Person /Agent

Telephone number of Facility contact person

Is this facility ☐ New or ☐ Existing? (Check one)

Describe generally the type of business or activities carried out at this facility:

C**Device Data**

Manufacturer

Model No.

RPBP

Double Check Valves

Size

Hot or Cold Water Unit

Location of Device

Bypass Arrangement (yes or no?)

From what type of contamination is the water supply protected?

How many other Reduced Pressure Backflow Preventers (RPBP) and Double Check Valves Assemblies (DCVA) are located in this building?

Type of Gate Valve (Gate Valves under fire systems must be UL-or-FM-approved.)

D**Cross Connection Plan Submittal Requirements****A. Plumbing Plan:**

1. Completed title block (name of facility, address, date, preparer, scale, etc.)
2. Schematic or blueprint of plumbing system (at least 8 1/2 x 11) using accepted Nomenclature, detailing:
 - Clearances in device installation (Height above floor and distance off walls)
 - Location of upstream and downstream shut off valves
 - Make, Model, size and alignment of device
 - Location of potable water lines
 - System, source, or equipment feed downstream of device, complete with information on the secondary system (operating pressure, chemical treatment, etc.)

When installation of devices involve large or complex plumbing systems, formal prints must be submitted with a Professional Engineers stamp, subject to the descriptions of the reviewing authority.

Submitted by _____

Of _____

Date _____

Telephone _____

Owner/Agent Signature _____

Date _____

Plumbing Contractor _____

License Number _____

Fire Sprinkler Contractor _____

License Number _____

All Backflow Prevention Devices must be approved for use in the Commonwealth of Massachusetts.

All materials, valves, tees, elbows, water piping, etc., must meet or exceed the "Williamsburg Water Department's" construction standards. The Williamsburg Water Department's Superintendent, prior to construction and installation, must approve any deviation from these standards in writing.

No backflow prevention device may be installed until the plumbing plan and related paper work is approved in writing by the Williamsburg Water Department. Also, any related permits required by the Williamsburg Plumbing Inspector must be obtained prior to construction and installation.

All Fire Sprinkler Contractors must obtain a permit from the "Williamsburg Fire Department" prior to construction and installation. A copy of this permit must be submitted to the Williamsburg Water Department before any backflow prevention device is installed.

For Water Departments Use Only

Installation Plan Approved _____

Installation Plan Rejected _____

Comments: _____

Cross Connection Inspector

Date

Superintendent

Date

Drawing



22-141 50 SHEETS
22-142 100 SHEETS
22-144 200 SHEETS

Drawing = NOT TO SCALE

11-3-03

VAC Pump

ABC Dental
10 Jones Rd.
Anywhere, MA

Prepared by:
123 Plumbing Co.
12 Smith Rd.
Anywhere, MA

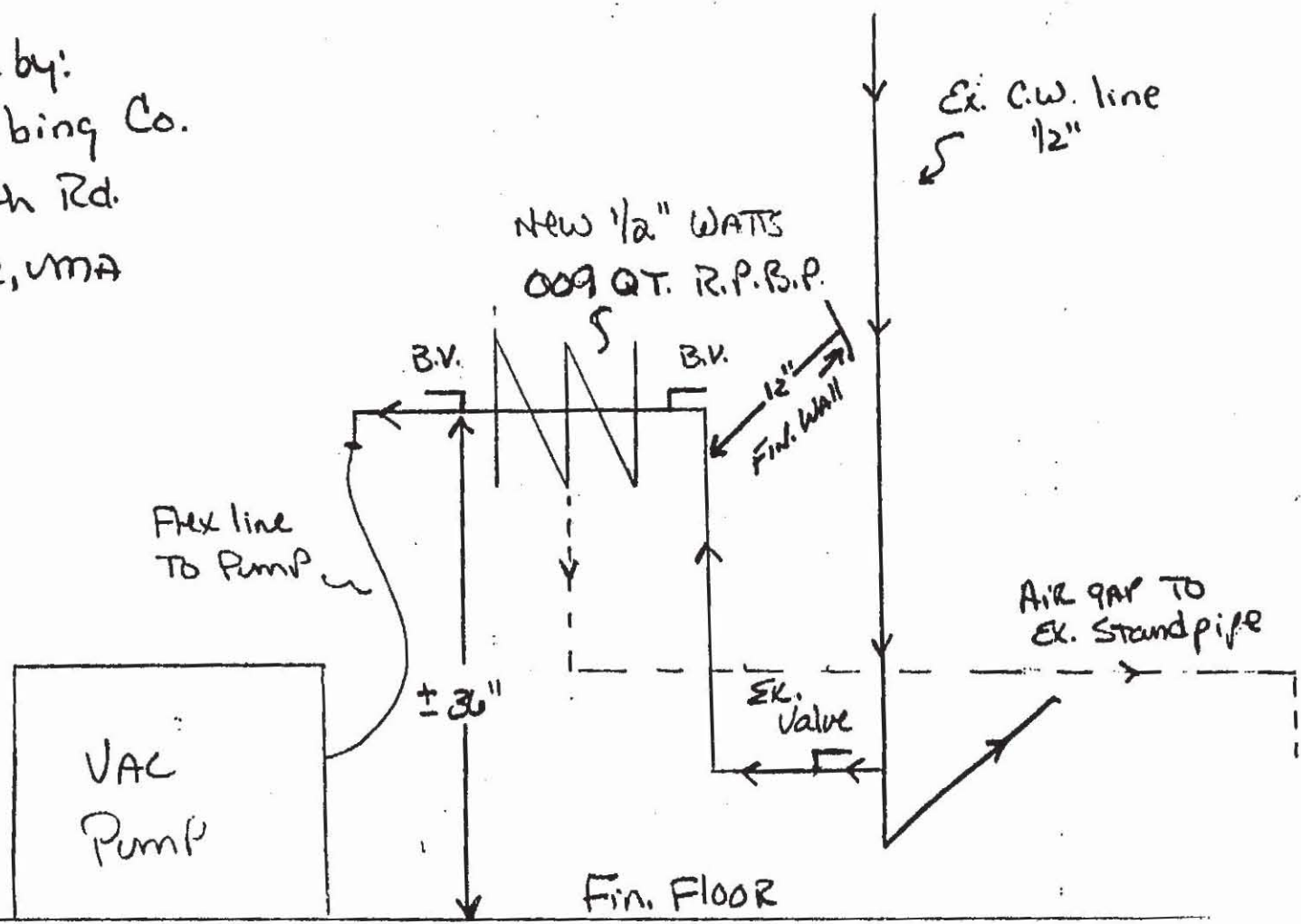

Drawing



22-141 50 SHEETS
22-142 100 SHEETS
22-144 200 SHEETS

Drawing = NOT TO SCALE

11-3-03

X-RAY Developer

ABC Dental
10 Jones Rd.
Anywhere, MA

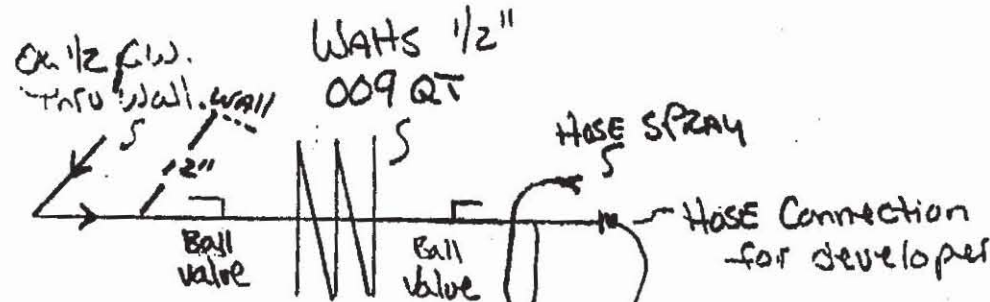

AIR GAP TO
STANDPIPE
IN CABINET

Developer

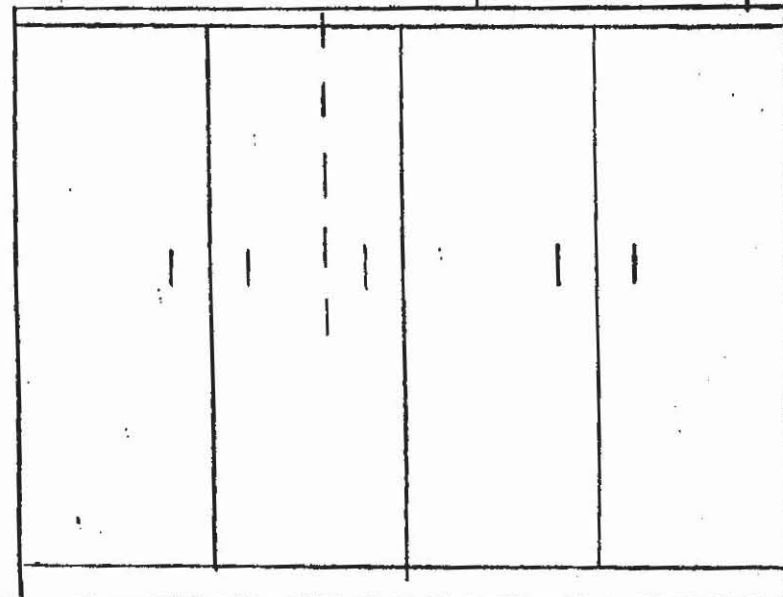

↓ Finished Floor ↓

Prepared by
123 Plumbing Co.
12 Smith Rd.
Anywhere, MA

Drawing = NOT TO Scale

6-6-06

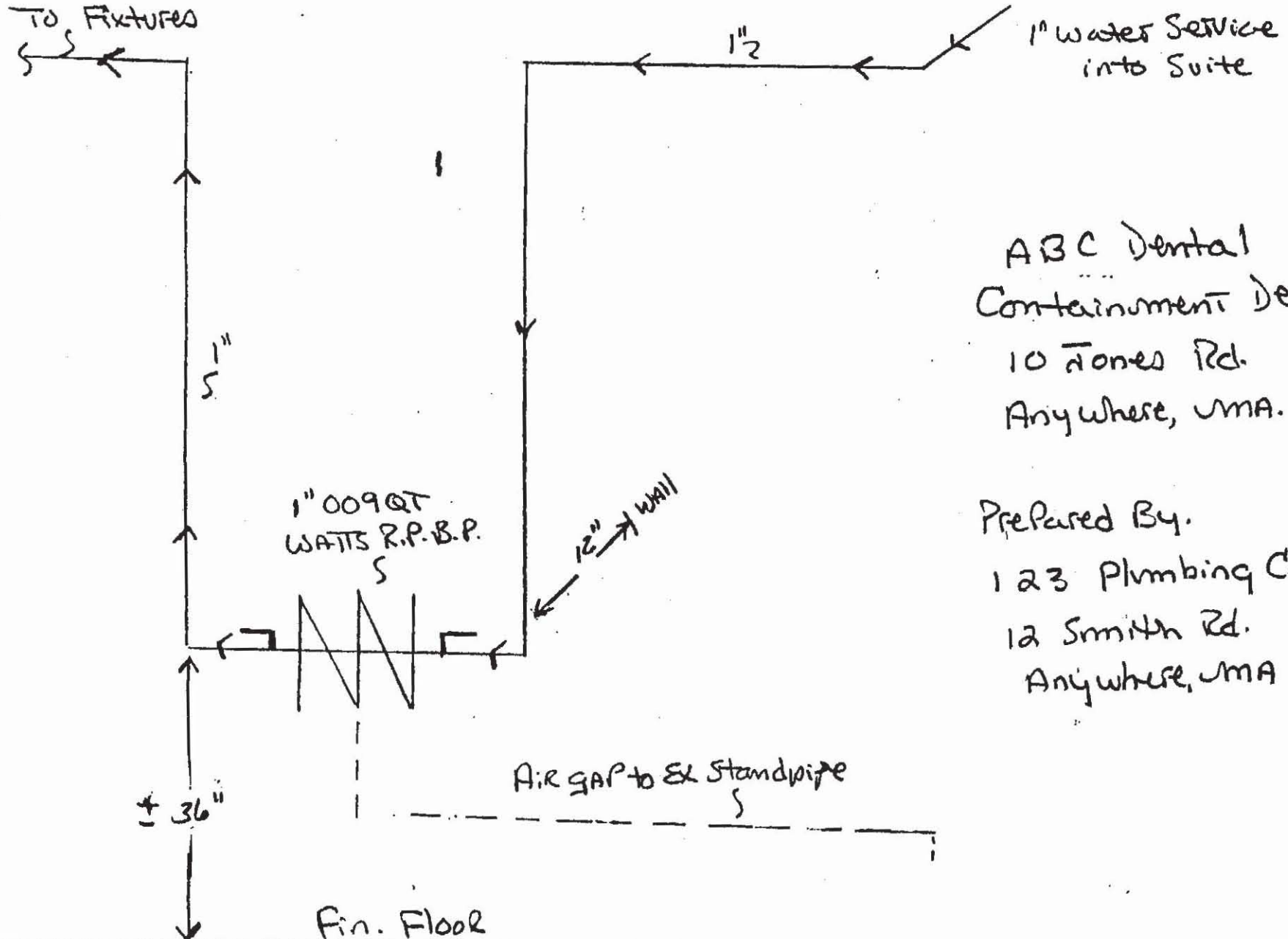

ABC Dental
Containment Device
10 Jones Rd.
Anywhere, UMA.

Prepared By.
123 Plumbing Co.
12 Smith Rd.
Anywhere, UMA