

G:\S:\DESIGN\2019\2018\180036_CEC-10 River Rd. Williamburg-Solar Site Asst\Drawings\NOV\180036 WATERSHED (5-30-2019).dwg
 Plotted On: Tuesday, June 11, 2019 - 12:48pm
 User Name: ocsolore

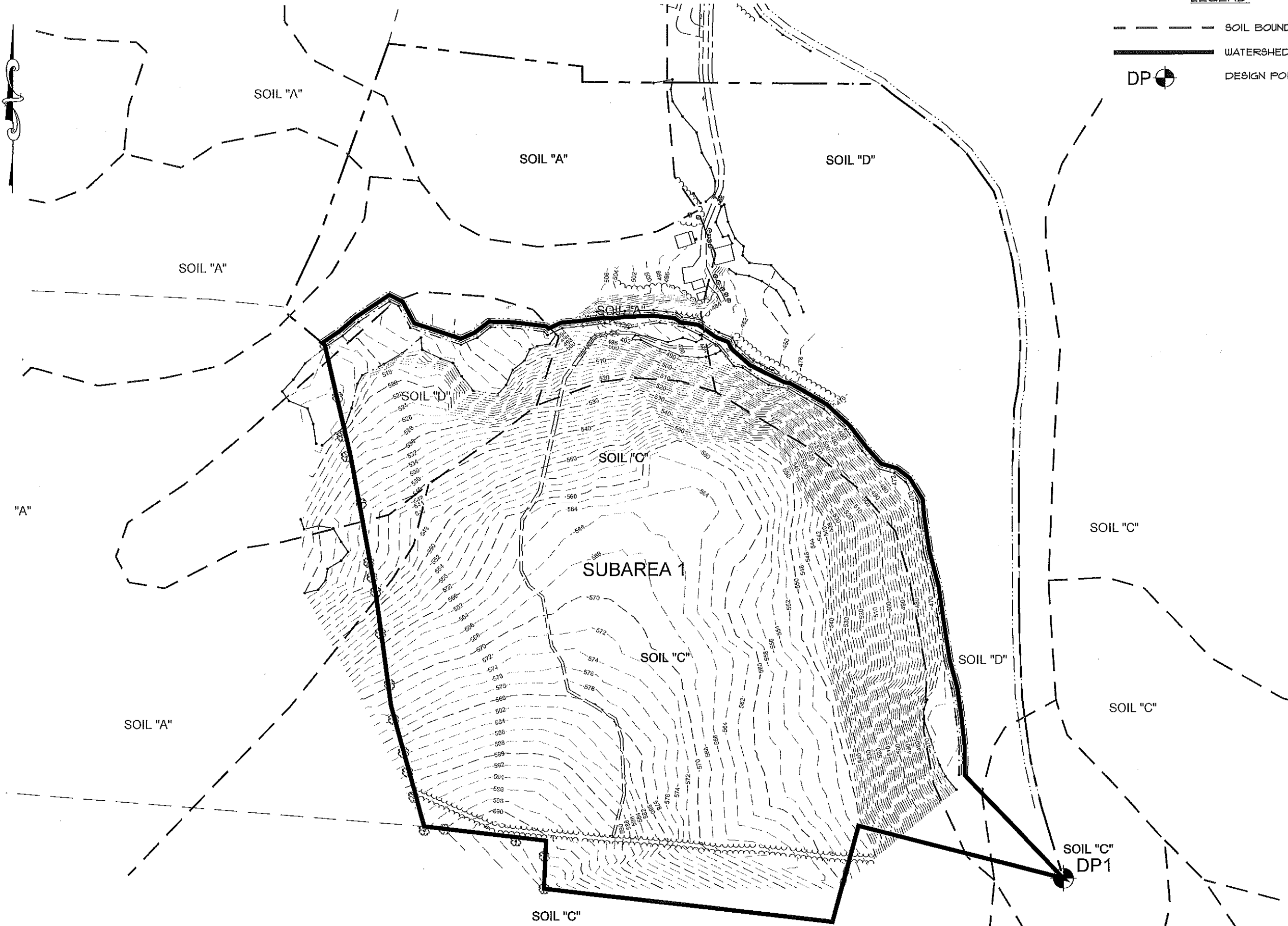

LEGEND

- SOIL BOUNDARY LINES
- WATERSHED BOUNDARY
- DP DESIGN POINT

SITE PLAN
SCALE: 1"=100'

PLAN TO ACCOMPANY NOTICE OF INTENT
 PREPARED FOR:
CLEAN ENERGY COLLECTIVE
 LOCATED AT:
 10 RIVER ROAD
 WILLIAMSBURG, MASSACHUSETTS

Design Group, Inc.
 Civil Engineers * Surveyors * Consultants
 2 FRANCIS AVENUE, WILMINGTON, MASSACHUSETTS 01897

PLAN DESCRIPTION:
EXISTING WATERSHED PLAN

SK DESIGN GROUP PROJECT #:
180036

COMMONWEALTH OF MASSACHUSETTS
 JAMES H. BOALUSE, II
 CIVIL ENGINEER
 LICENSE #00883
 PROFESSIONAL EXP. 2/1

REVISIONS:	
DRAWN BY: AJMS	CHECKED BY: JMS II
ORIG. DATE: MAY 8, 2019	SHEET NO. 1
ISSUED FOR: PERMIT	OF 2
SCALE: AS NOTED	

