





# CONTRIBUTIONS & COMMUNITY INPUT

## GRANTS:

\$48,000	2015 Rec Trails Program, DCR
\$47,000	2017 Rec Trails Program, DCR
\$100,000	2018 Rec Trails Program, DCR
\$100,000	2021 MassTrails Program, DCR
\$247,600	2022 MassTrails Program, DCR
<b>\$65,000</b>	<b>2017 Town Meeting 2017 (Route 9 Corridor Survey)</b>
\$9,999	2017 Healthy Hampshire/Mass in Motion
\$30,000	2020 MA Attorney General settlement funds
\$30,000	2014 State Transportation Bond funds
<b>\$2.4m</b>	<b>2020 State Transportation Bond funds (pending)</b>

## DONATIONS

\$2,300	2017 Valley Gives Day
\$17,000	2017 Donations from local businesses
\$8,000	2018 Jim Locke memorial gifts
\$7,800	2018 Skinnerville Park donations

## SMITH COLLEGE DESIGN CLINIC (4) (IN-KIND VALUE \$15,000)

2015-16	South Main/MassCentral Trail Dismount
2017-2018	Brassworks Area Hydraulic Study
2018-2019	South Main/MassCentral Trail Dismount
2021-2022	Skinnerville Park Bridge Study

## COMMUNITY FORUMS (8)

2016	
2017	
2017	Revelation Day Event
2019	
2019-2020	MVP community planning process
2021	Children Imagine the Greenway (with ATD School)
2022	
2023	

## TOTAL FUNDS TO DATE:

**\$642,499 grants & donations**  
**\$65,000 town funds**  
**\$2.4M pending**

# Four Segments of the Mill River Greenway

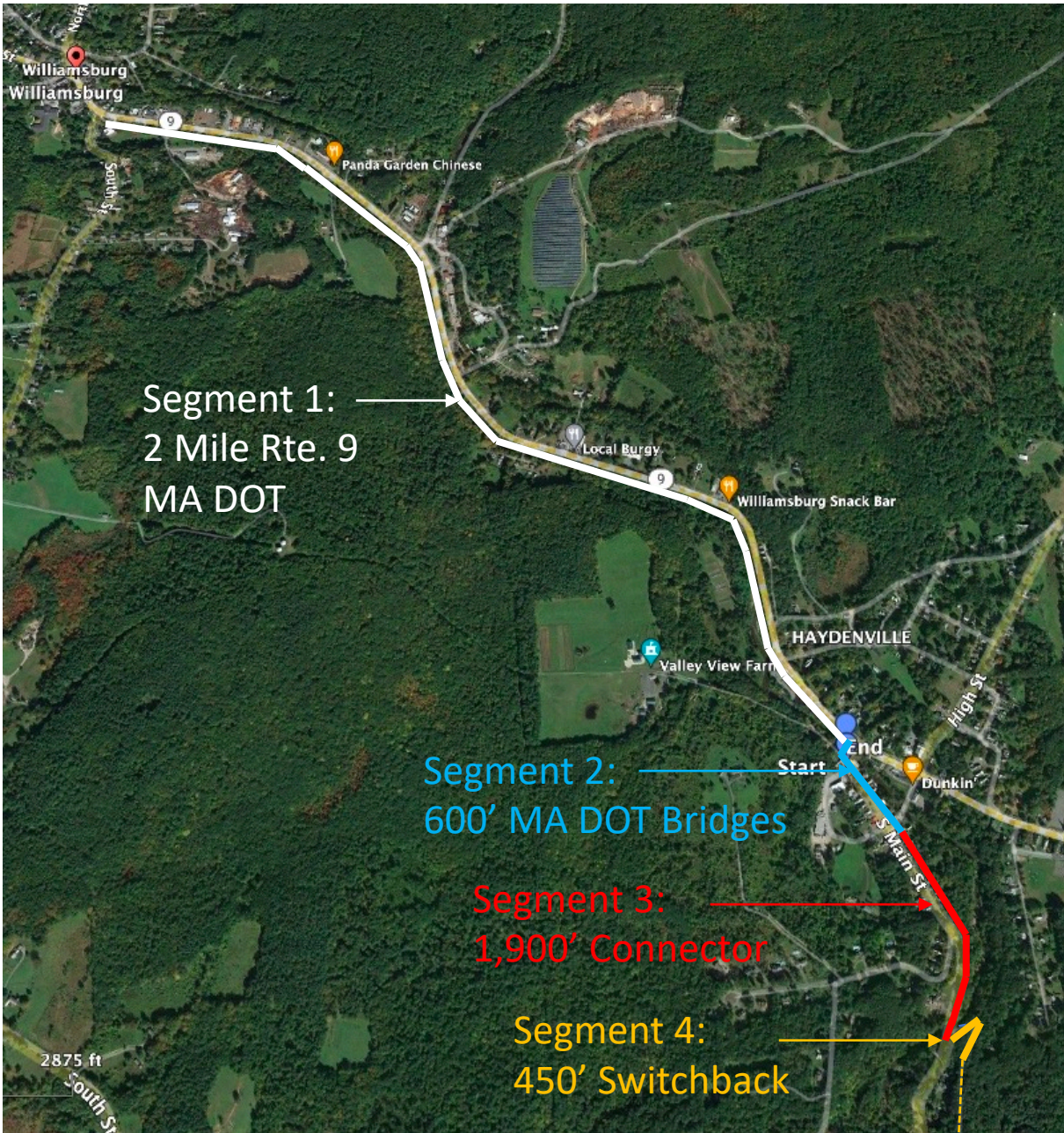

1: MassDOT/ District 1

2: MassDOT/ District 1

3: T-Bond/ MassTrails

4: (MassWorks/ MassTrails)?

WMRGC has worked with our Engineering Consultants, VHB through preliminary designs for Segments 1, 3 and 4.







# Greenway View South at the Common

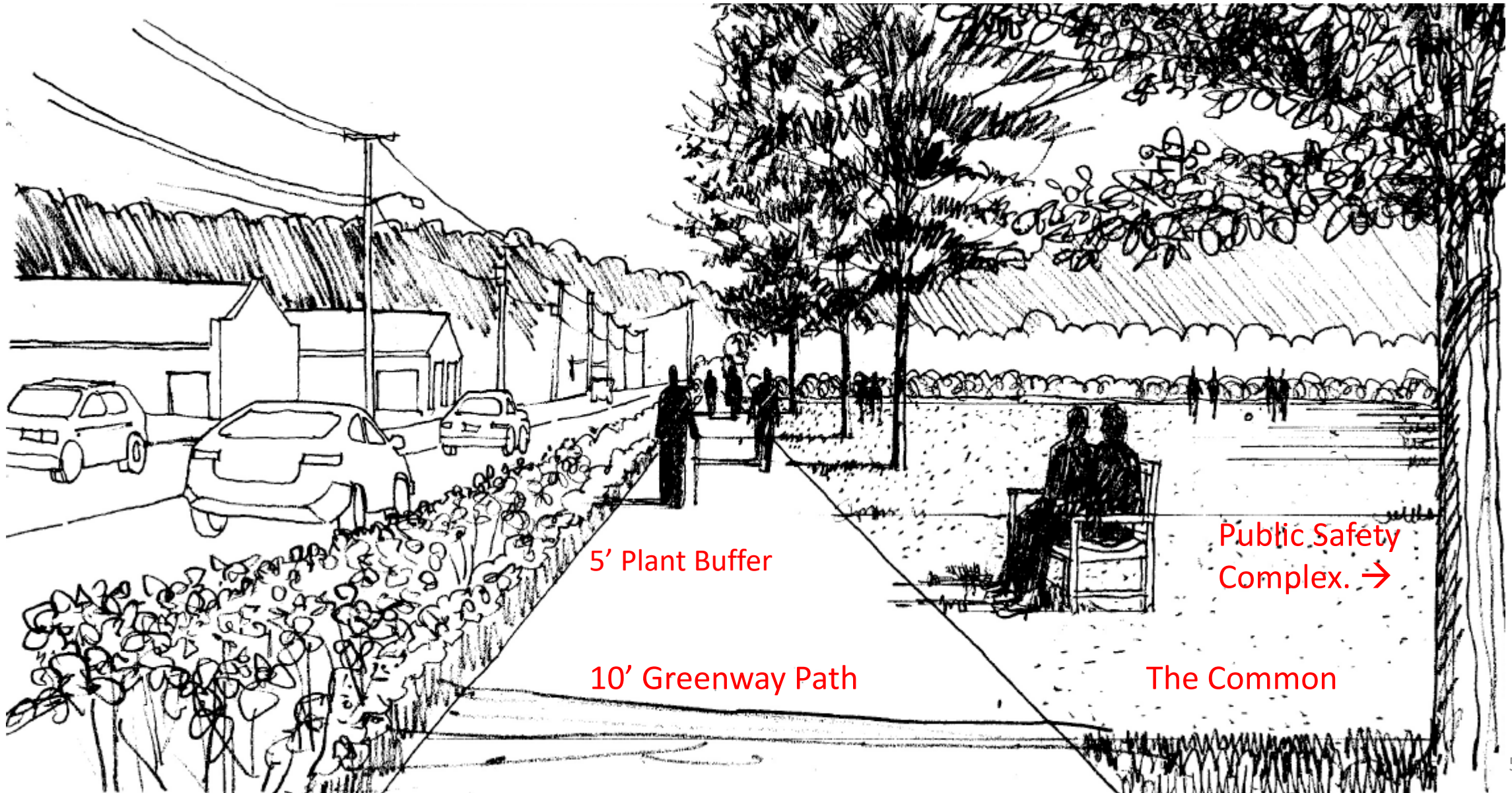



# Extending the Gardens into the Greenway: Existing Route 9 Public Gardens

---





# Rte. 9 Section Toward River Road: Viewing East

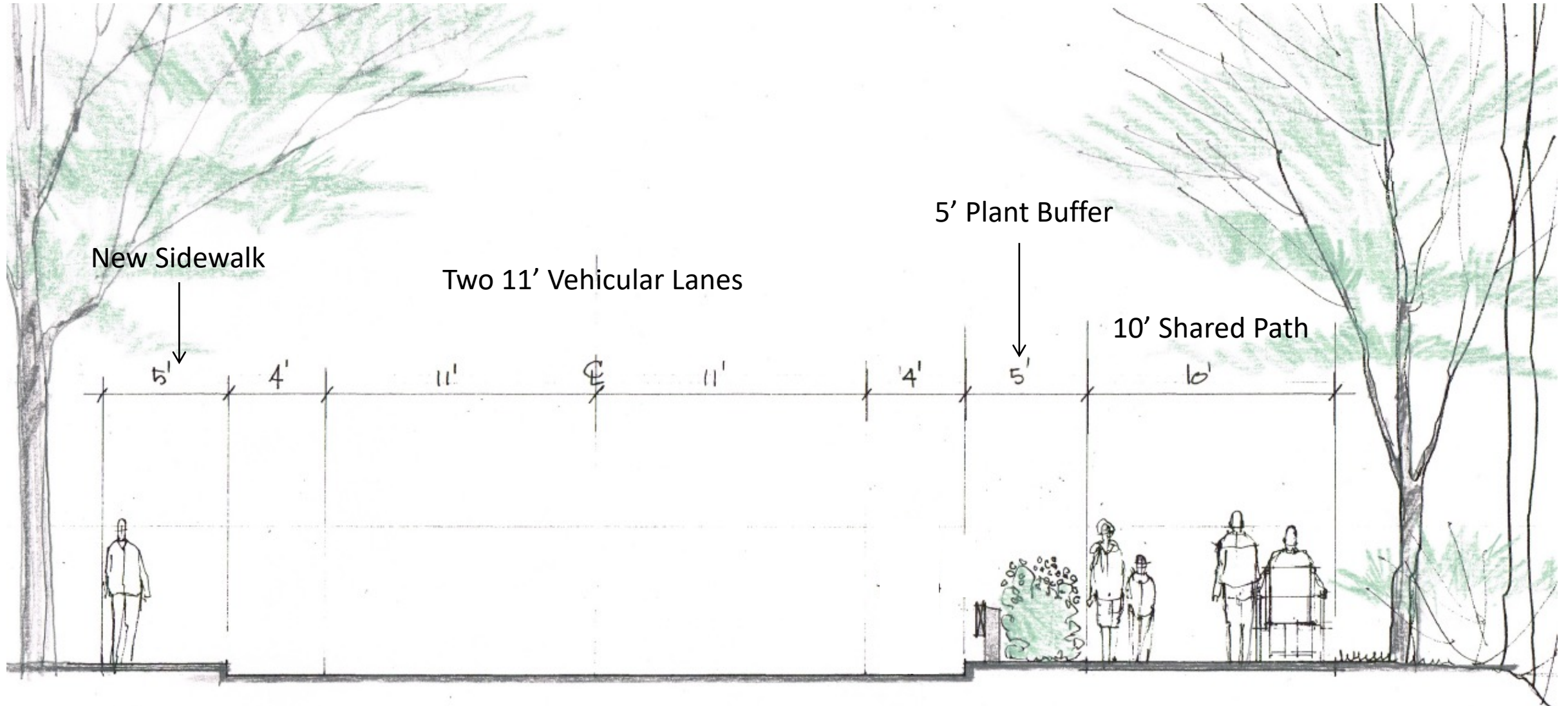

# Bridge to Proposed Skinnerville Conservation Park Trails

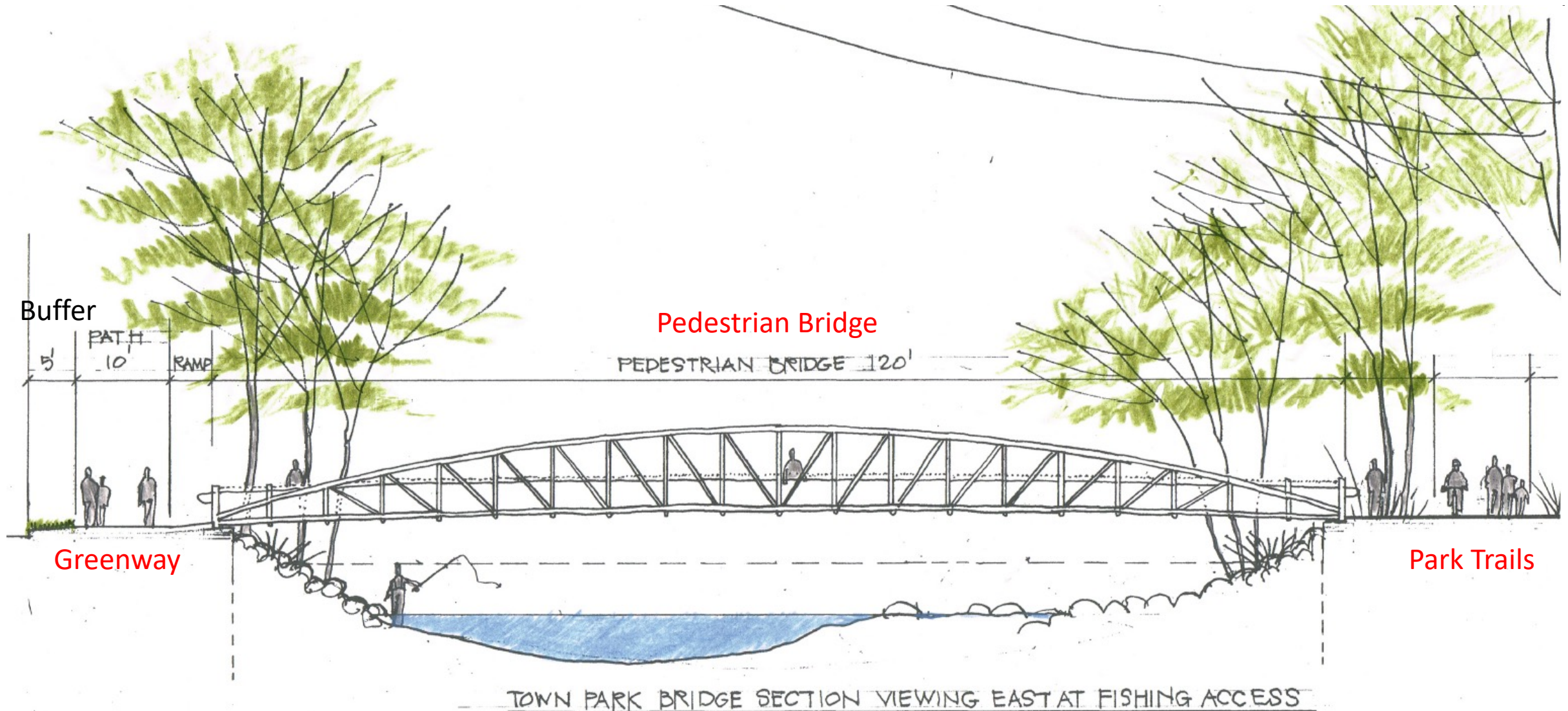



# Detail at Pondview Rd. Bank

---



# Greenway at Rte. 9 Mill River Bend: Viewing West

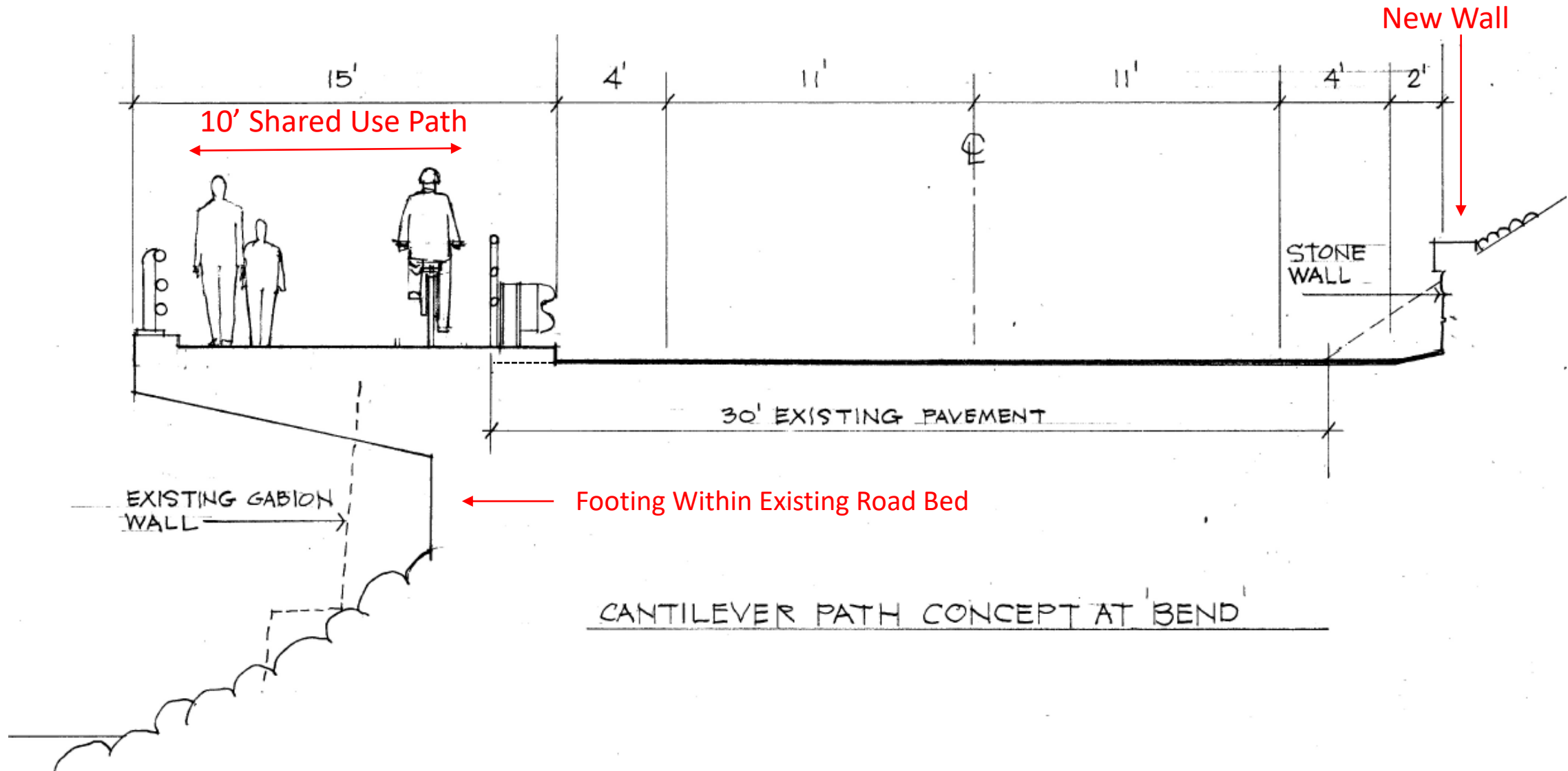



# Brassworks to S. Main St. Library Bridge

---





# Greenway at Brassworks Entrance

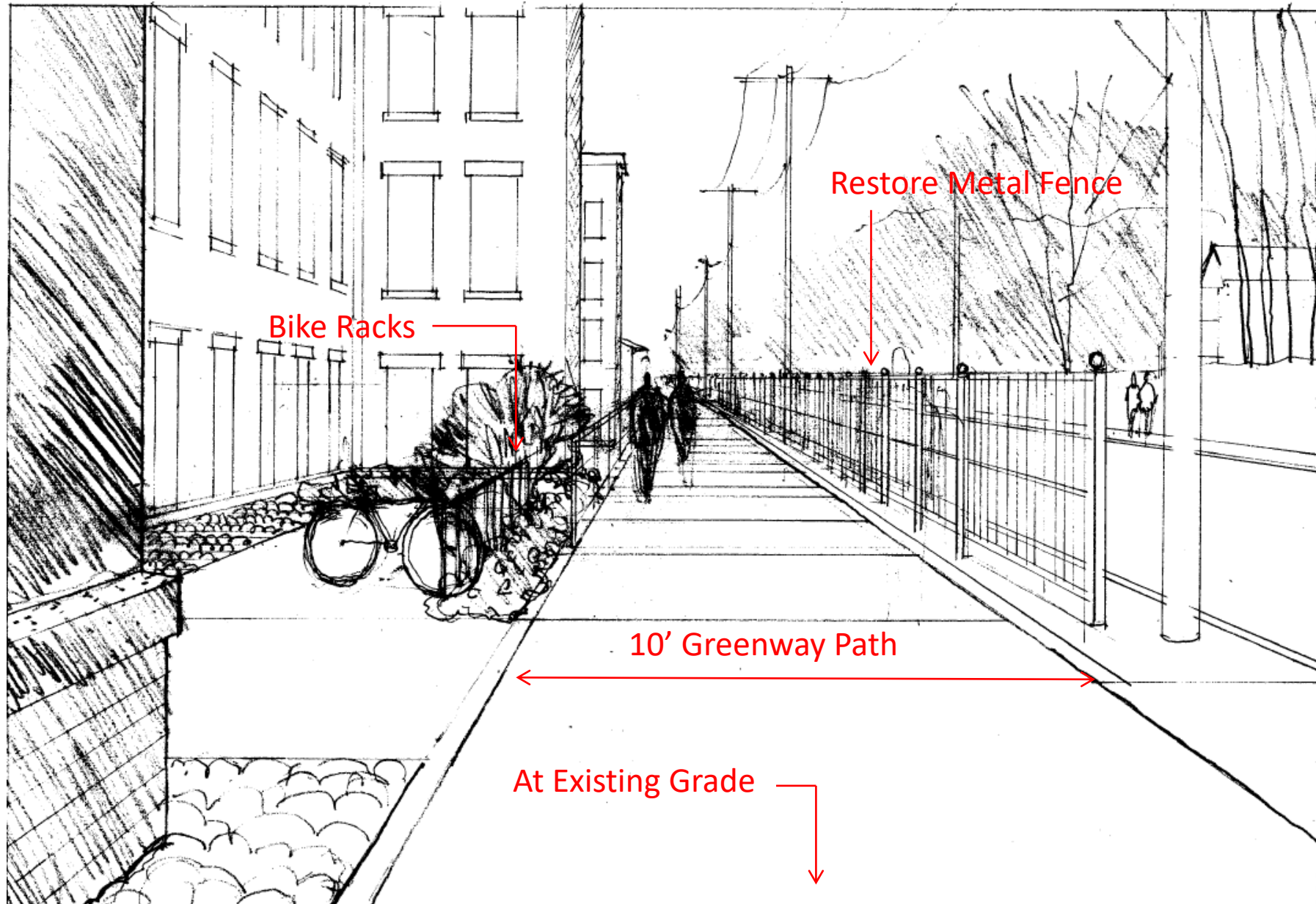



# Brassworks Parking Lot Adaptation

---

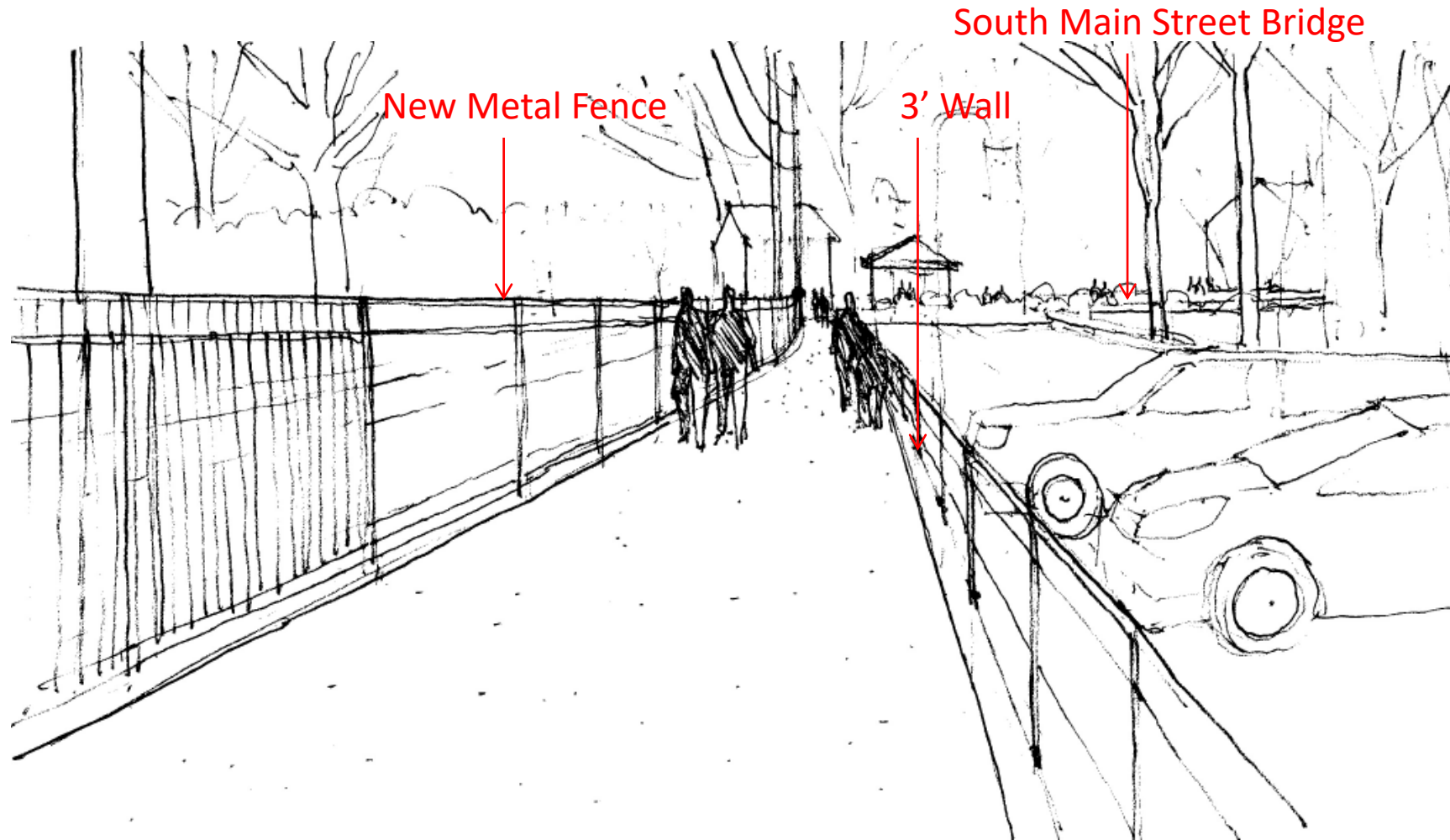

# South Main St. Bridge at Rte. 9





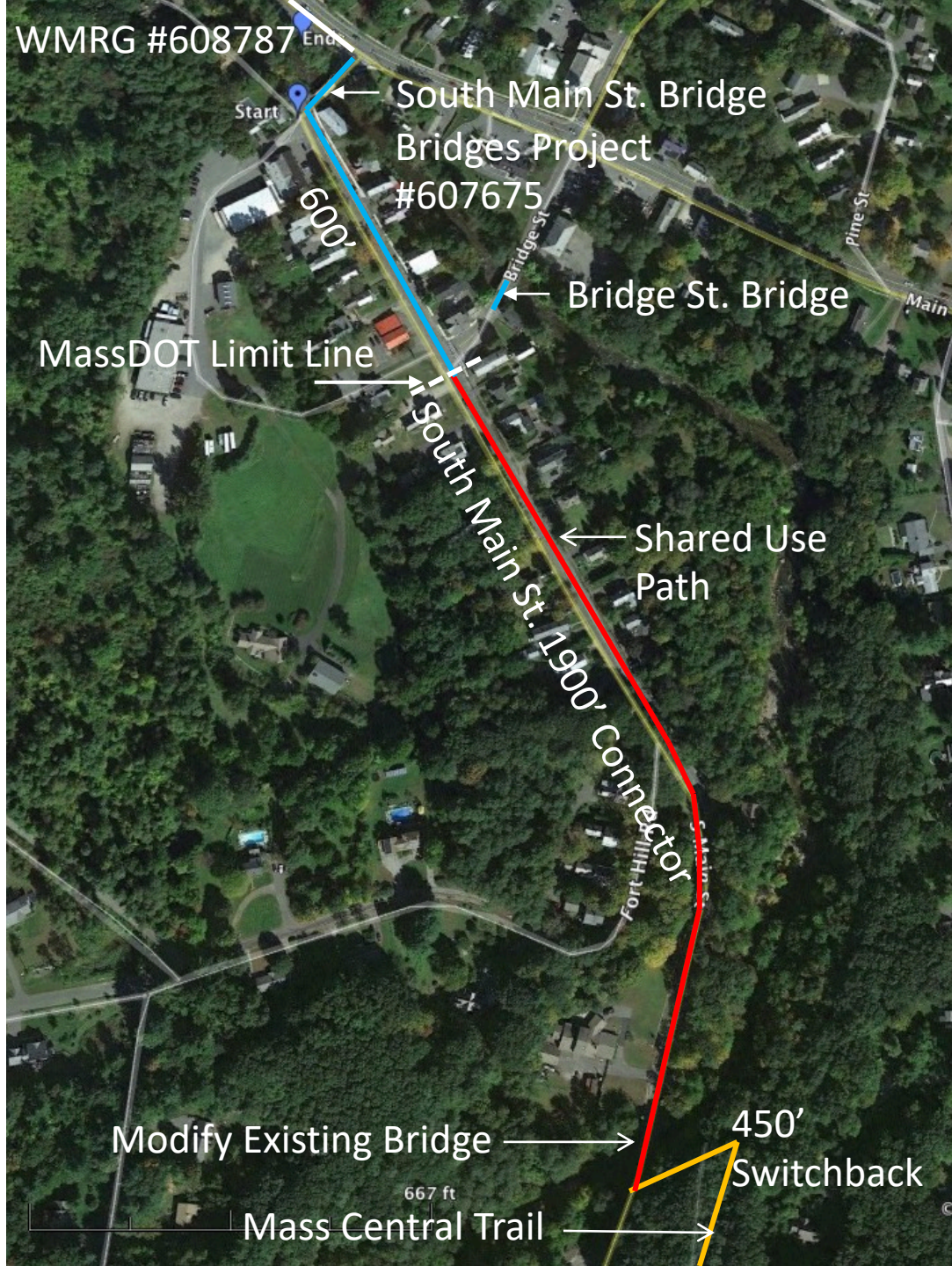

# South Main Street Connector to the MassCentral Trail

- Create New Shared Path
- Install On-Street Parking
- Modify Existing Bridge
- Provide Mass Central Trail Access at Switchback



# South Main St. at Bridge St. Viewing North

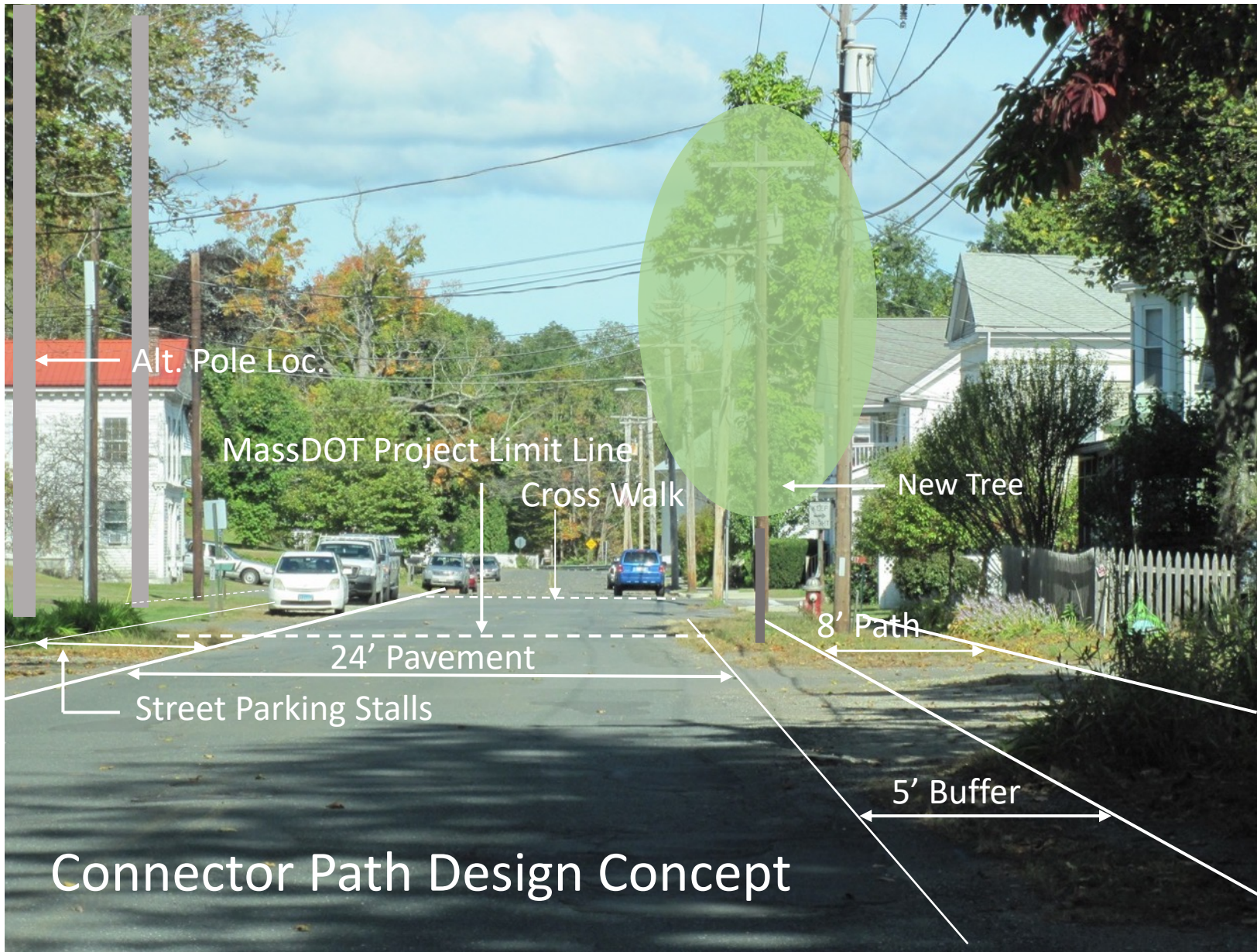

North end of Connector at the MassDOT Bridges 'Project Limit Line.'

Design Concept is confined within existing South Main Street Right of Way (R.O.W.).

Illustration shows an alternate location of Utility Poles and a green buffer for tree planting.

Water line has been moved to the west side of the road.



# Upper South Main Street: Typical Plan Elements

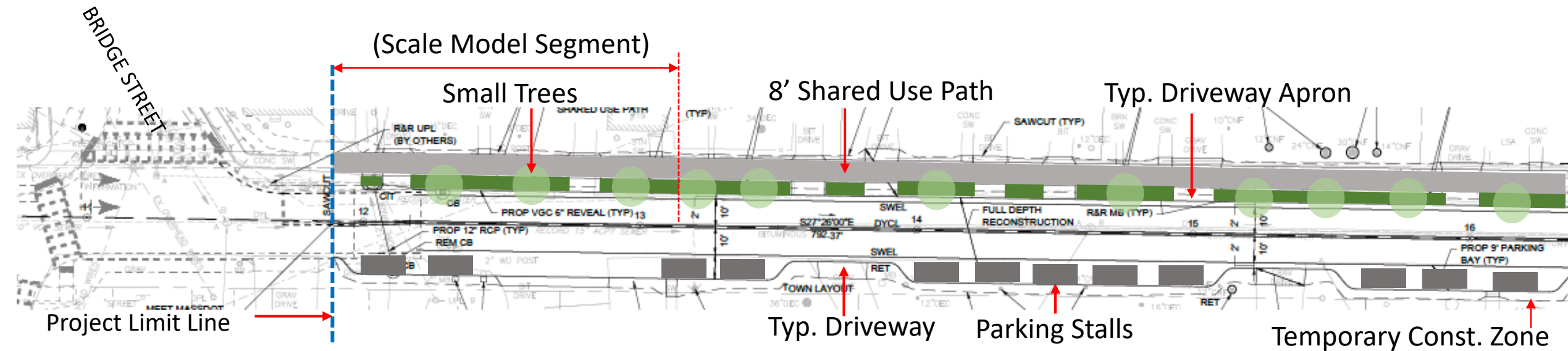

- Install South Main Street Connector Path
- Rebuild Street to Improve Existing Utilities, Pavement and On-Street Parking
- Accommodate Existing Driveways and House Access Within the Public R.O.W. & Temp. Const. Zones

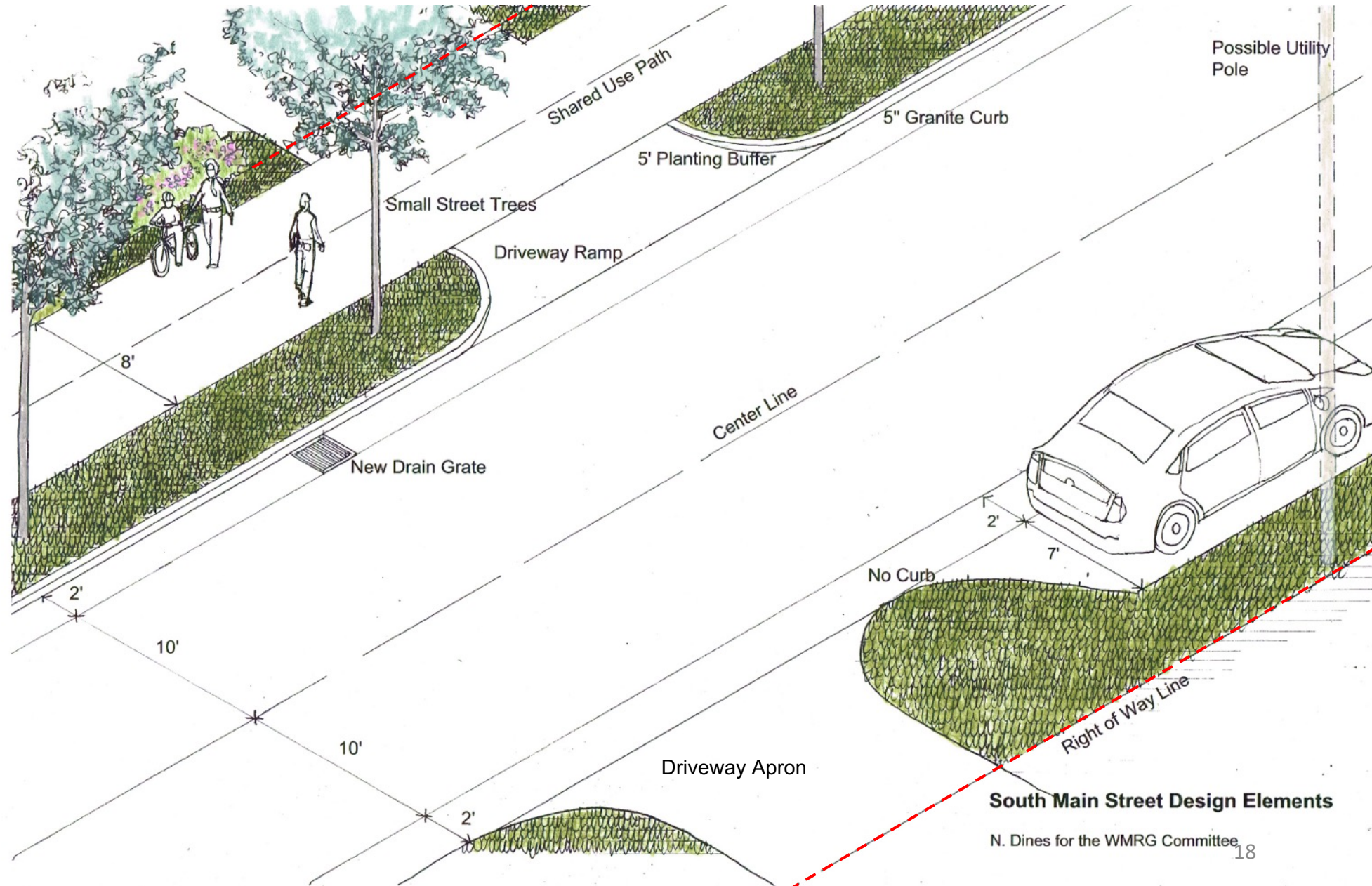

10' TRAVEL LANES  
WITH PARKING ON  
WEST SIDE.



# South Main Street Section: Viewing South

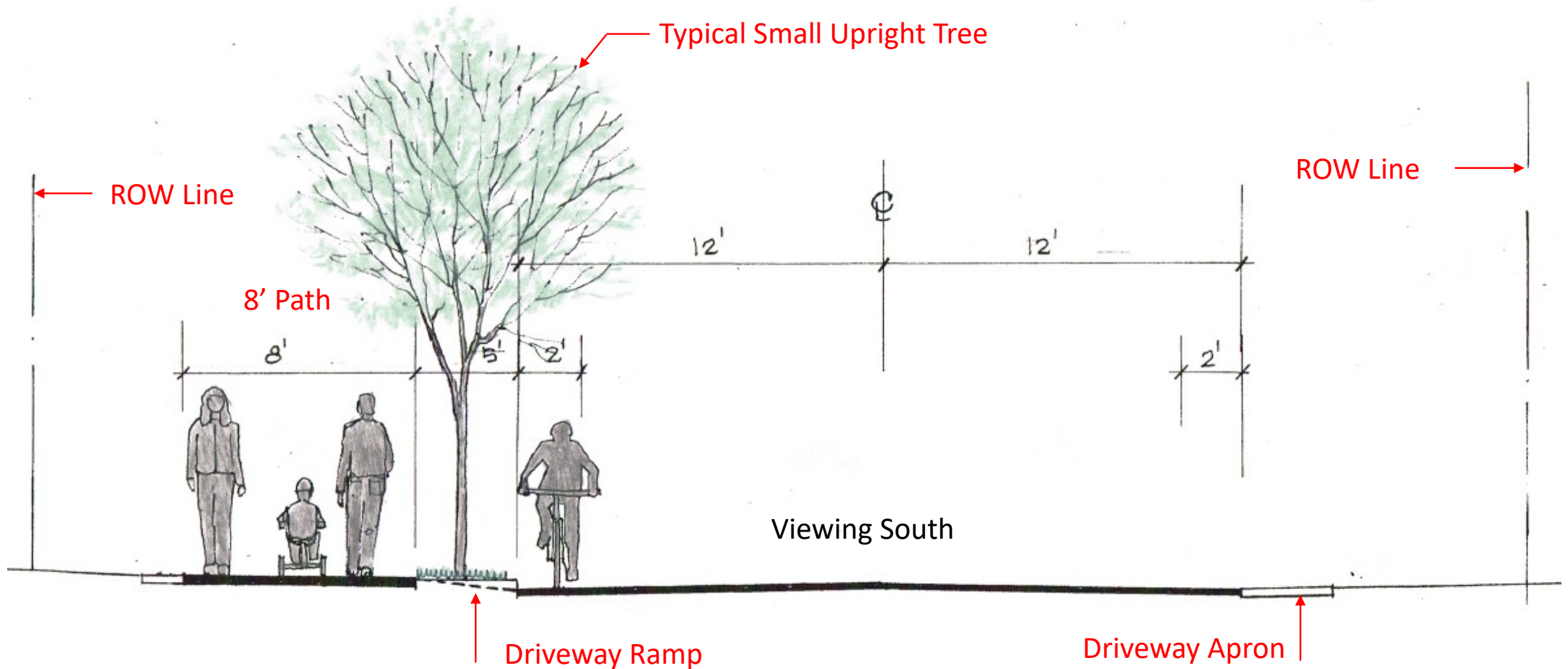

# Street Design Elements Model

The proposed Shared Use Path fits within the existing sidewalk and street pavement edge, as well as the Right-of- Way line.

Temporary Construction Zones will help to blend the new construction with established lawns, walks and driveways.

Curbs provide a containment for a 5' planting buffer and driveway apron ramps.







# Aerial View of Connector Path

Road retains its existing width and adds a granite curb to define the 5' planting buffer and driveway ramps.

Alternate location of Utility Pole is shown on the west side of the street.

On-street parking is shown on the west side of the street that shows no curbing at the street edge.

# South Main Street Connector: Viewing North

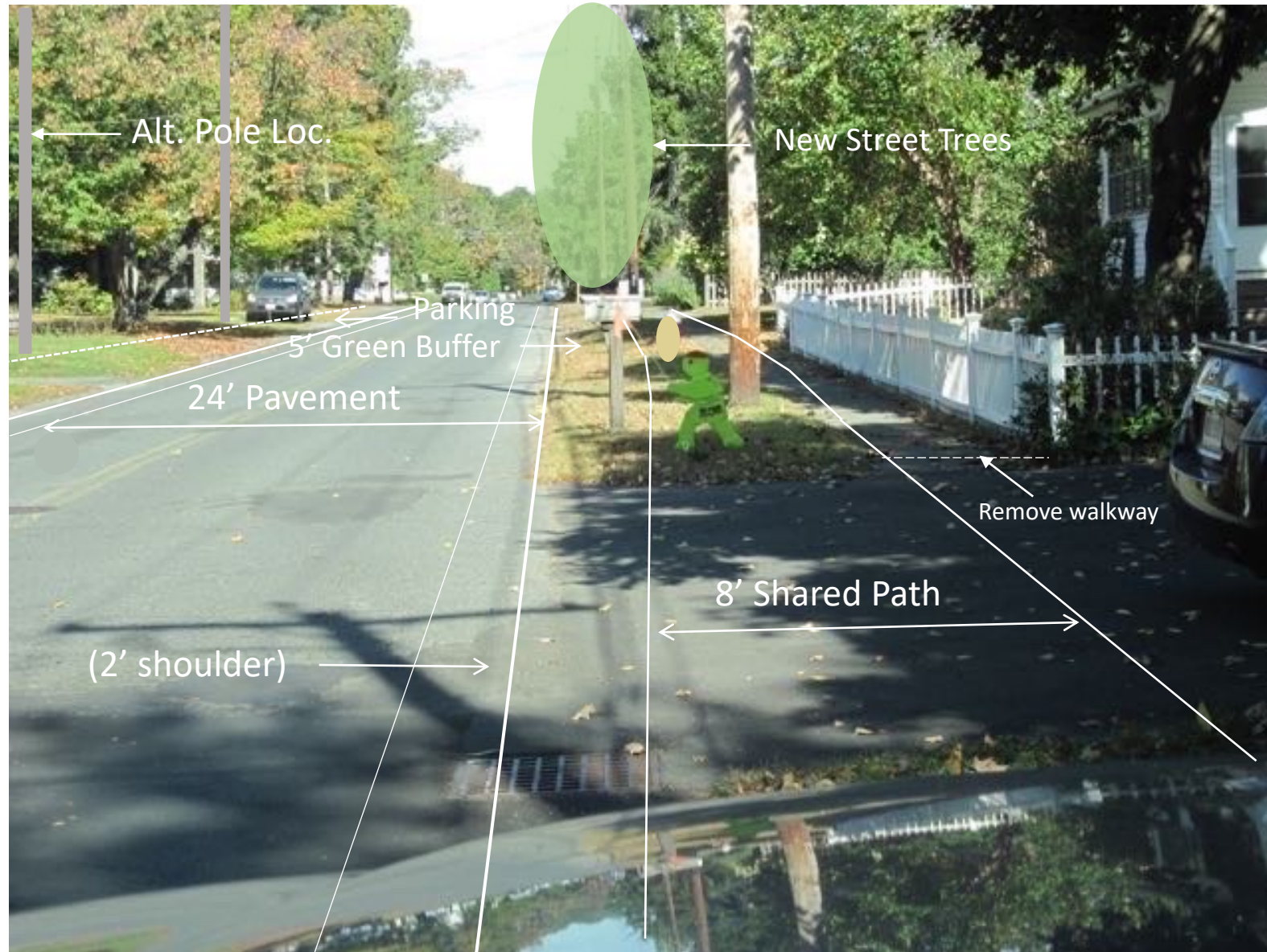



# South Main St. at Ft. Hill Intersection: Viewing North





# Simulation of Path at Fort Hill Road Intersection: Viewing South

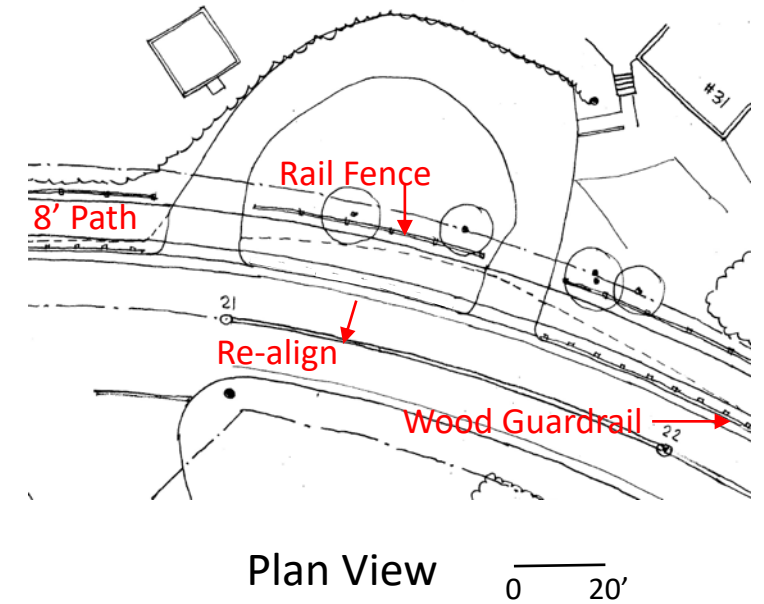



# Connector Path Link to Pedestrian Bridge: Viewing South

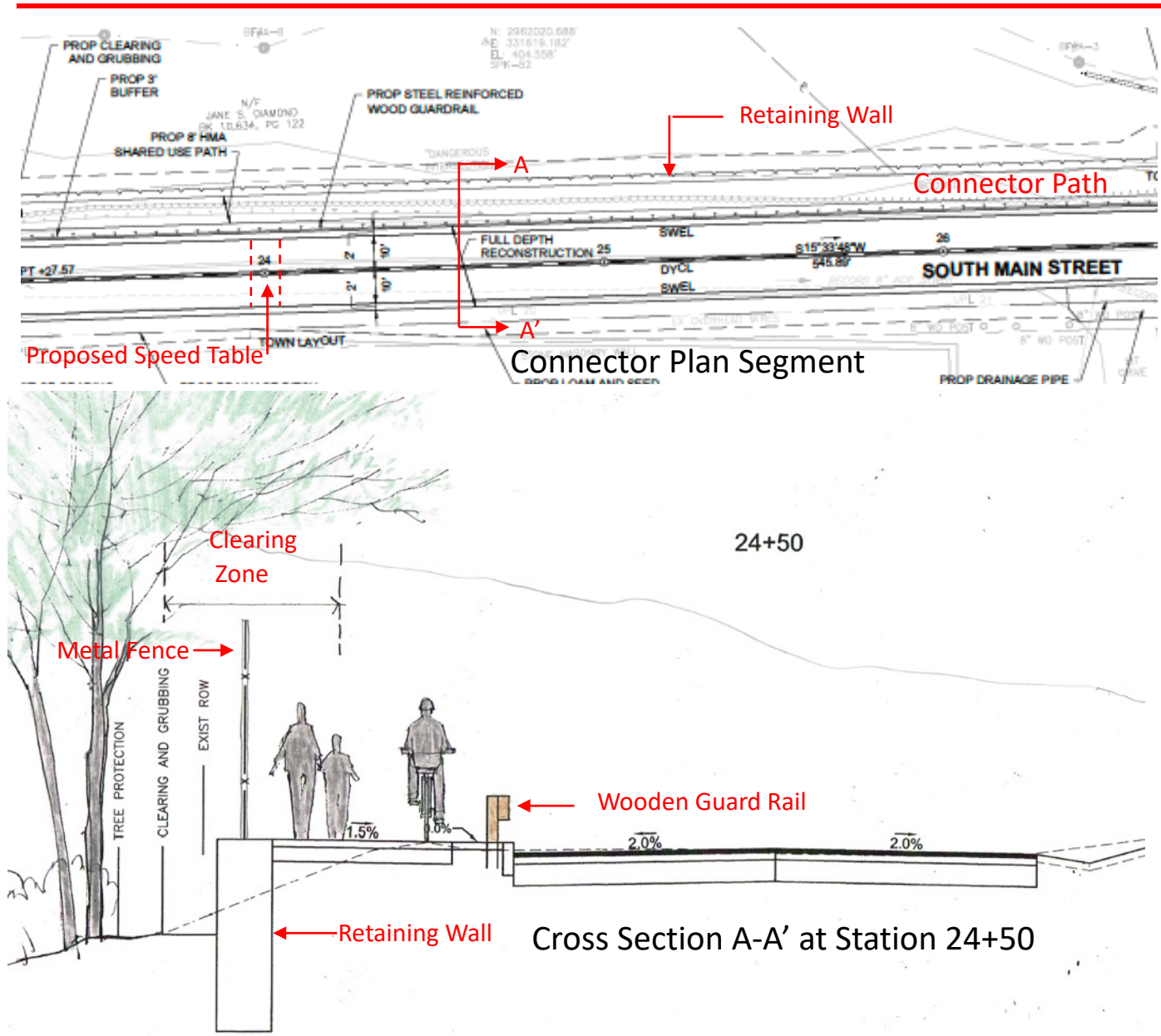

# Shared Use Path Over Concrete Bridge: Option 1

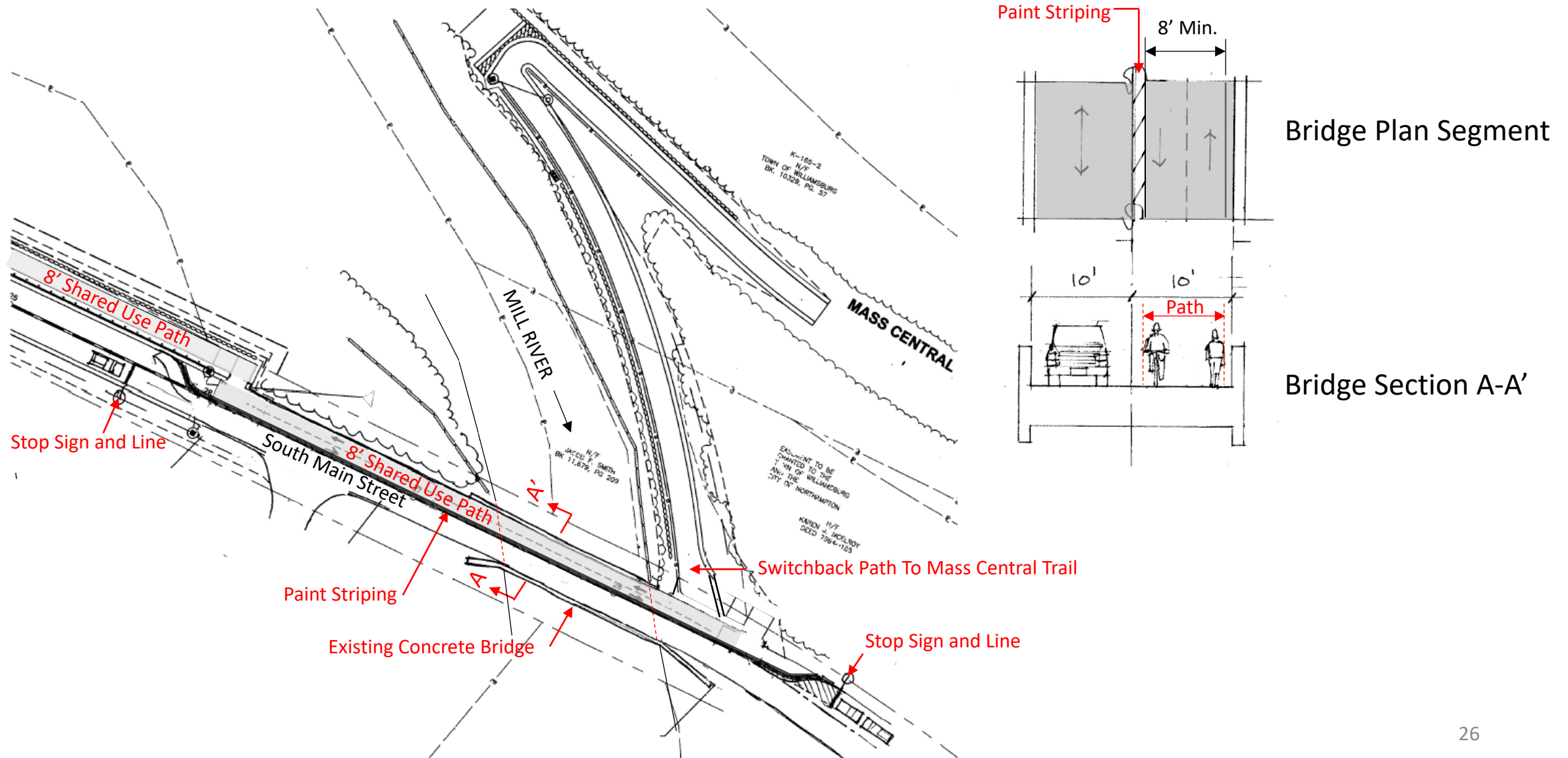



# MassCentral Trail Dismount: Path Section

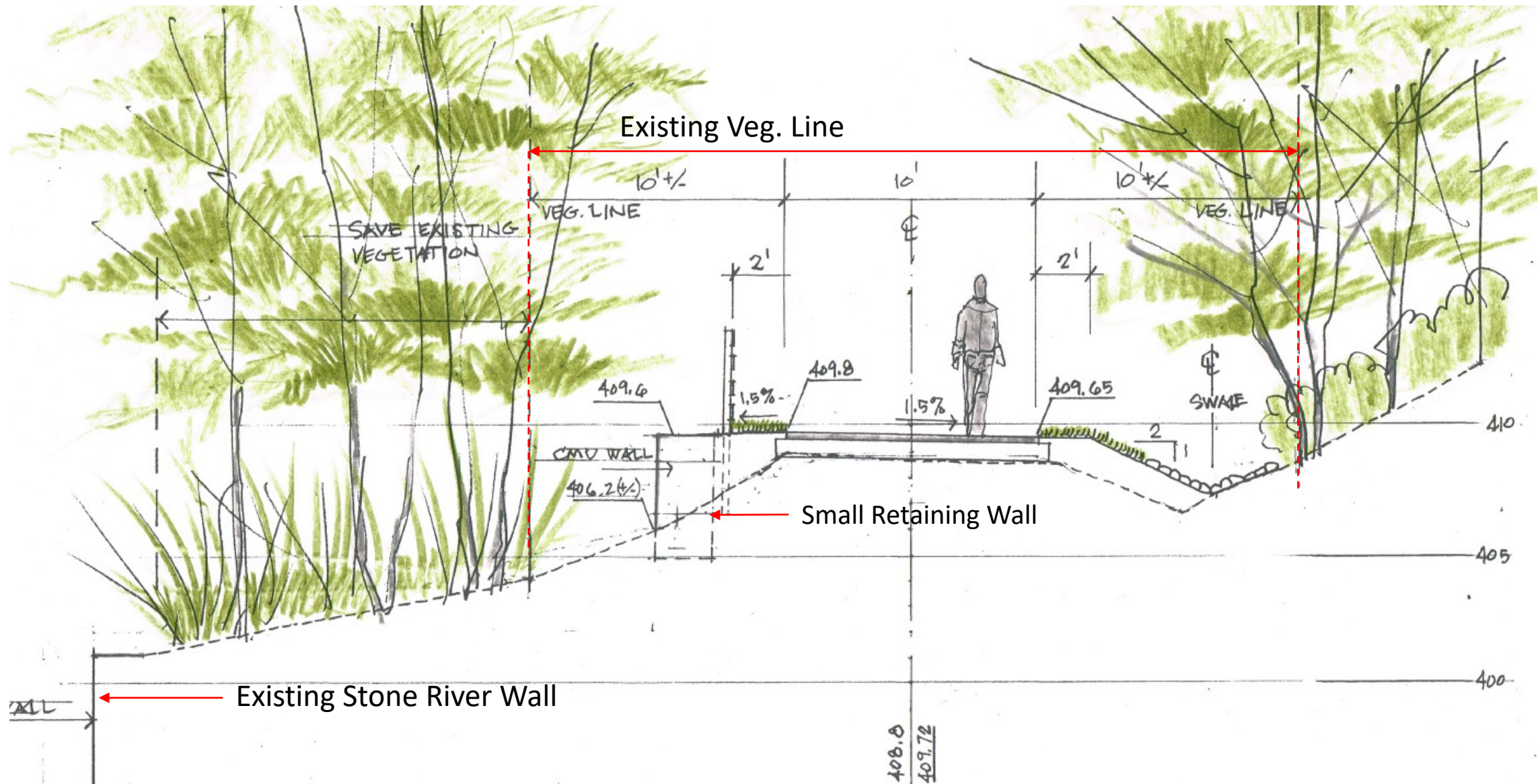

# MassCentral Trail Dismount: Seating and Retaining Wall at Switchback

